



LiftMate LEPT13 POWERED PALLET TRUCK

The **LiftMate LEPT 13** is a compact, low cost, powered pallet truck designed for horizontal pallet movement in light to medium duty applications. It is perfectly suited to businesses that wish to upgrade from hand pallet trucks to safe, comfortable and productive pallet handling. Retail operations, small stores, manufacturing sites – in fact any operation that utilises hand pallet trucks – will find the LEPT13 an indispensable help.

- Light enough to be used on mezzanine floors and vehicle tail lifts
- Robust and strong enough to handle loads of up to 1300kg
- Choice of sizes to suit UK and Euro pallets



FEATURES & BENEFITS:

- Safe and effortless moving of pallets
- High mobility in confined spaces due to its compact size
- Outstanding stability
- Easy pallet entry
- Rechargeable from any wall socket
- Maintenance free batteries
- Choice of sizes - 520, 540 or 680mm wide, 1000 or 1150mm long forks
- Hard wearing, powder coated paint finish
- Minimum maintenance costs
- High quality components
- Easy accessibility of serviceable parts
- Grease nipples on all moving components
- All models CE marked

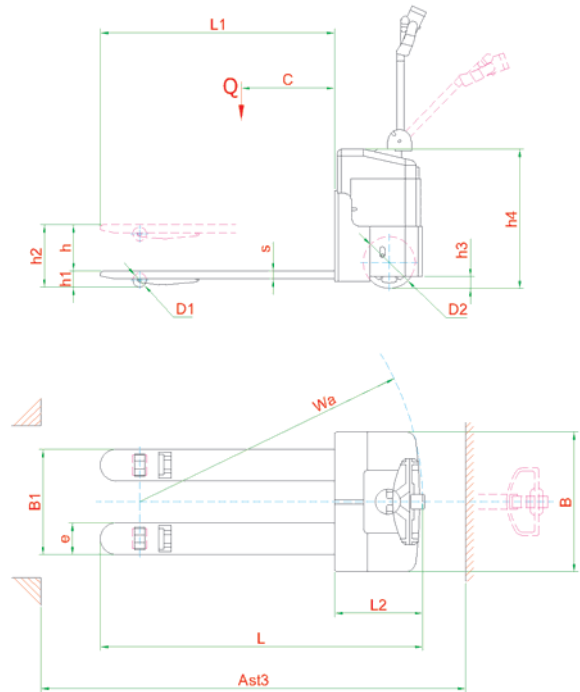

	MODEL	LEPT 13
Q	Capacity	1300kg
C	Load Centre	600mm
h1	Lowered Height	75/85mm
h2	Raised Height	194/205mm
B1	Width Over Forks	520/540/685mm
L1	Fork Length	1000/1150mm
s	Fork Thickness	44mm
L	Overall Length	1420/1570mm
L2	Rear Length	420mm
B	Overall Width	704mm
Wa	Minimum Turning Radius	1234/1384mm
Ast3	Aisle Width (800 x 1200 pallet)	1540/1720mm
Ast3	Aisle Width (1000 x 1200 pallet)	1720mm
	Maximum Travel Speed (laden)	4.6 km/h
	Maximum Travel Speed (unladen)	5.9 km/h
	Gradeability (laden)	5%
	Gradeability (unladen)	7%
	Service Weight (without battery)	244kg
	Service Weight (with battery)	292kg